

INTEGRATED LIFTING SYSTEM FOR MYBLOCK CHEMICAL TOILET



T BLUSTAR SRL
Via Trentino Alto Adige,4 -
53036 Poggibonsi – (SI)

TABLE OF CONTENTS

SAFETY PICTOGRAMS	
Errore. Il segnalibro non è definito.	
1. LIFTING OPERATIONS	4
1.1 INTEGRATED LIFTING DEVICE	4
1.2 LIFTING AND HANDLING	5
1.3 POSITIONING	6
1.4 SCHEDULED	
MAINTENANCE.....	7

SAFETY PICTOGRAMS

	Description
	Driver of lifting and handling equipment. A trained and authorized operator able to use lifting equipment (especially tower cranes and truck mounted cranes) for loading and unloading materials. The operator follows all instructions given by the manufacturer of the lifting equipment, in compliance with the regulations in force in the country of the user.

	Danger! Suspended loads
	Do not pass within crane radius when operating
	Periodically check ropes, chains and lifting accessories
<div> MYBLOCK CHEMICAL TOILET MAX. LOAD CAPACITY 400 kg. </div>	Pay attention to the weight of the chemical toilet before lifting operations

1. LIFTING OPERATIONS

1.1 INTEGRATED LIFTING DEVICE

The integrated lifting device is essentially a metal structure bolted and integrated inside/outside MyBlock portable chemical toilet. This device allows to lift the toilet during loading, unloading, transport and placement operations.

Once the lifting device has been chosen with the toilet, it avoids to employ any other external system for lifting operations. The internal device frame is fixed to the roof, along the walls down to the floor plates. It is part of the chemical toilet and support it when lifted. The external roof eyebolt is the only lifting point, therefore it is sufficient to insert the crane hook into the eyebolt to carry out lifting and handling operations.

The maximum working load of the chemical toilet is 400 kg.

The net weight of the lifting device is 18.5 kg.



MyBlock portable toilet external view



Complete lifting device frame

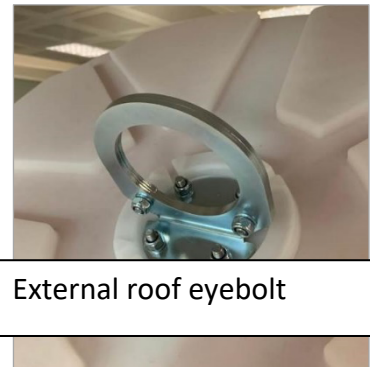

External roof eyebolt



Internal frame fixed to the roof



Internal frame fixed to the walls and to the floor

1.2 LIFTING AND HANDLING

**MYBLOCK
CHEMICAL TOILET
MAX. LOAD
CAPACITY**

400 kg.

MyBlock chemical toilet must be handled with lifting equipment suitable for supporting its weight and dimensions. It is important to avoid damages to each toilet, to people and to nearby properties.

Lifting equipment types suitable for lifting chemical toilets are mainly:

- Jib cranes
- Tower cranes
- Mobile cranes
- Truck mounted cranes



Lifting operations must be carried out by trained and authorized personnel only.



The manufacturer is not liable for damages caused to people or things for using not suitable lifting equipment.

Always check in advance the correct weight balance of the chemical toilet, when lifted and handled, in order to prevent unexpected movements such as dangerous oscillations.

Since the chemical toilet can be lifted with the aid of hooks, ropes and chains, make sure that the condition and features of these lifting accessories are fit to be employed for the weight to be lifted.

Before starting the lifting operations, the lifting equipment operator must ensure that the movement path is clear and without people.



Do not pass within crane radius when operating.



All crane hooks employed must be provided with a safety latch, to prevent unhooking of the eyebolt.

1.3 POSITIONING

The positioning of the chemical toilet requires a respect area in the chosen place suitable for the size and lifting means selected.

Place the chemical toilet in a place with a free space around it, which may allow normal use operations, filling of the water tank, cleaning and maintenance operations. In compliance with ergonomics principles, leave a minimum distance of 500 mm. from the walls of other toilets.

The support surface must be smooth, levelled and capable to withstand the toilet gross weight. The final level adjustment must be done through the appropriate support feet. The assembly of any disassembled parts and the commissioning of the chemical toilet is carried out directly upon delivery.

**BAGNO CHIMICO
MYBLOCK
CARICO MAX. DI
ESERCIZIO**
400 kg.

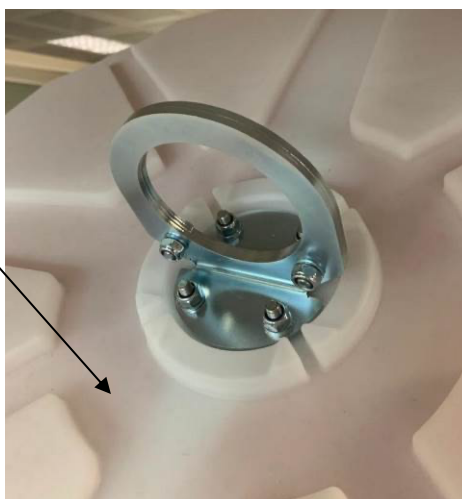

T BLUSTAR S.r.l.

53036 Poggibonsi (SI) - www.tblustar.com



MODELLO **Dispositivo di sollevamento integrato MyBlock**

MATRICOLA **01/21**

MASSA A VUOTO **18,5 kg**

ANNO **2021**

CARICO MASSIMO
DI ESERCIZIO **400 kg**

1.4 SCHEDULED MAINTENANCE

Each MyBlock integrated lifting device is built, assembled and tested directly in the manufacturer's factory, before shipping and delivery of the chemical toilet.

However, over time it is necessary to implement a series of checks to maintain the reliability and safety of the device.

The following table shows the interventions to be carried out periodically by a maintenance technician.

Check area	Type of intervention	Frequency
Check tightening of the fixing screws which link the metal parts of the lifting device frame.	Check that all screws connecting the metal frame parts are properly tightened.	Monthly
Check wear and tear of the lifting device metal frame.	Check that the metal frame is intact and in good condition with no corrosion points.	Half yearly
Check wear and tear of the external plastic structure of the chemical toilet	Perform a thorough check for corrosion, abrasion and shocks. The extreme outside temperatures of use and aging can deteriorate the polymer that makes up the structure of the chemical toilet.	Every 5 years

The maintenance technician assigned to the toilet control operations must wear the following personal protective equipment:



For any further request or information not included in these instructions, please contact the manufactures technical service (tel. +39 0577 1793364).

myBlok

Assembly instructions

**Istruzioni di
montaggio**

	TB-BLU-04	Long rivet / Rivetto a testa larga 5x25
	TB-BLU-05	Washer for Rivet / Rondella per rivetto DIN 125A ZN B. D 6,4 D. EX. 24 - Thickness 1.44 mm
	TB-DOOR-0000014	Small Rivet / Rivetto piccolo 4,8x16
	TB-BLU-021	Rivet to reinforce Base / Rivetto di rinforzo per la base 4,8x30
	TB-BLU-10	Screw to Reinforce Door / Vite di rinforzo porta 5x40
	TB-BLU-11	Screw to Reinforce Door/ Vite di rinforzo porta 5x35
	TB-BLU-12	Screw to Reinforce Door / Vite di rinforzo porta 5x45
	TB-BLU-02	Panel to Door Latch Bracket for Lock/ Piastra per lucchetto
	TB4-RP-022	Nut / Dado cieco M5
	TB-DOOR-07	Washer / Rondella 5.3X15X1.25
	TB4-RP-020	Screw / Vite M5x16
	TB4-RP-023	Washer/ Rondella M6

1.



2.

SX

DX



3.

DX

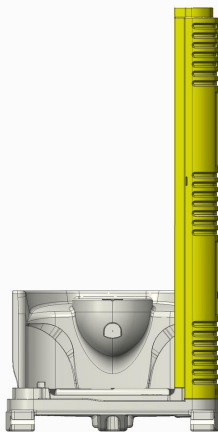

3.



4.

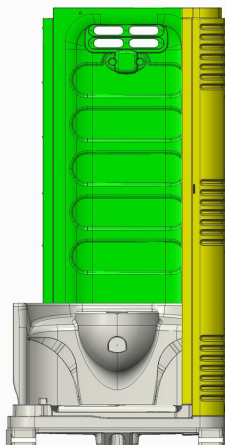

4.

FRONT

REAR

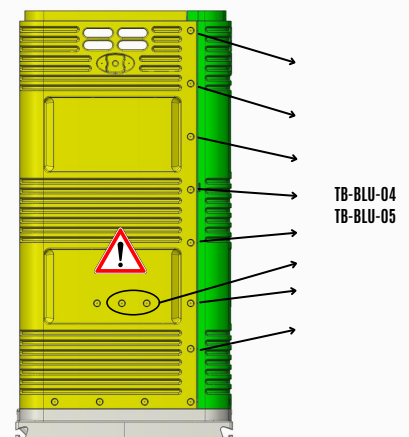

5.

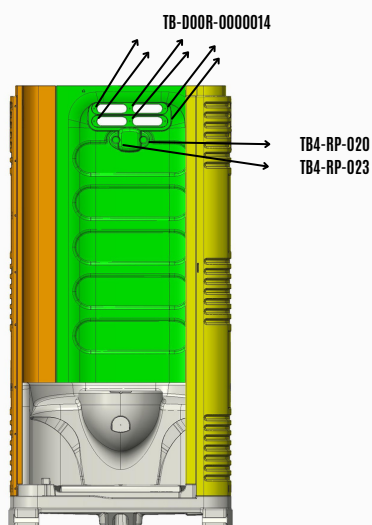

5.

SX

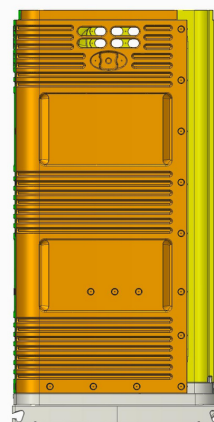

6.

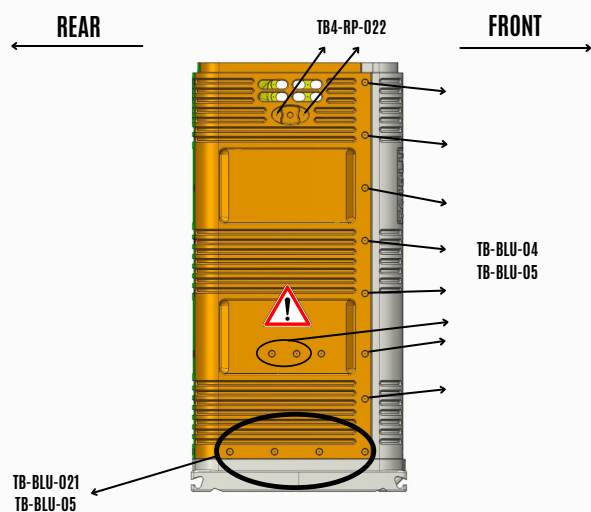

7.

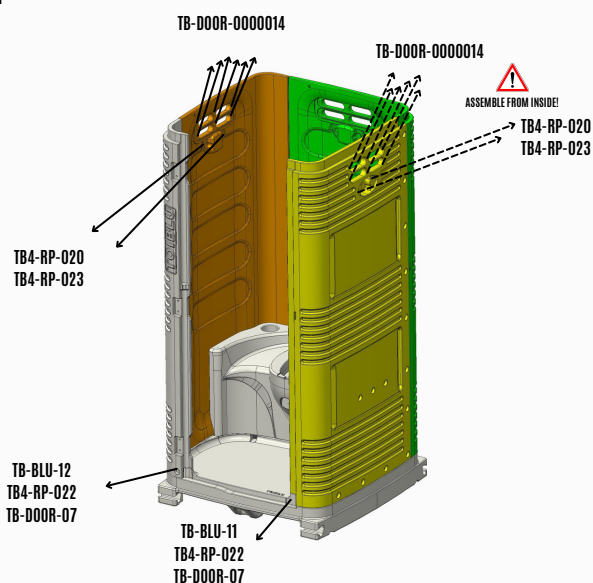

8.



9.



9.

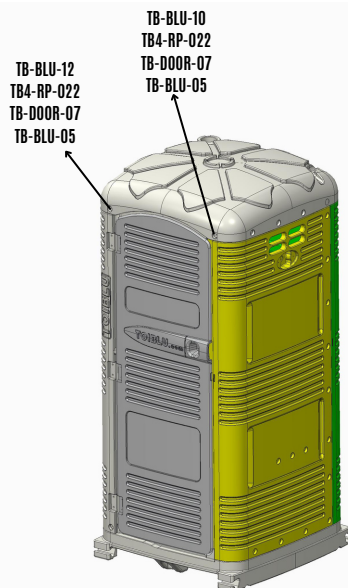

10.

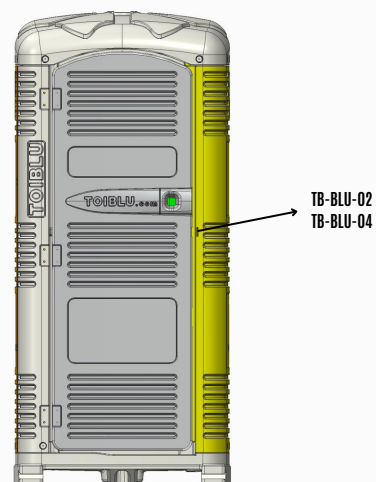

11.

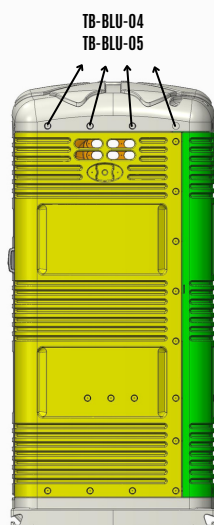

12.

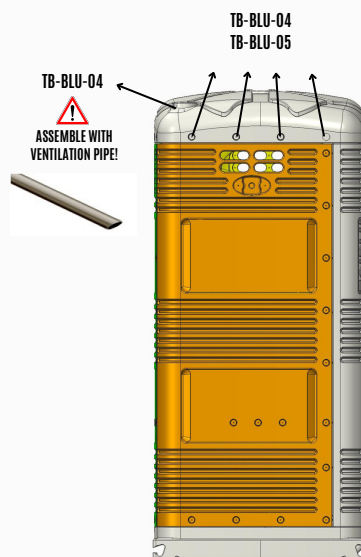

13.

